



VISCOUNT

Classico

Digital Piano

User Manual-EN

Safety Guideline

Before playing the digital piano, please read the following content. Please put this instruction book in a safety place, in order to read it in the future.

Warning

In case of getting seriously injured or killed because of electric shock, short circuit, damage, fire or other dangers, please obey the following warnings. These warnings include but not limited to the following situations:

Power/Electric Cable

- * The rated voltage of this device is fixed. The required voltage is printed on the nameplate of this device.
- * Check the plug regularly, clean the dirt and ash piled up on the plug.
- * This digital piano only matches with the provided power cable and plug.

- * Please don't put electric cable beside heaters or radiators. Don't bend too much or cause damage to electric cable. Don't put any heavy stuff on the wire. Don't put it where it may be run over or trampled to make people stumble.

Do Not Open

- * Please do not open this device and try to dismantle inner components or transform it in any ways. This device does not include any components for users to fix. If you find any problems, please stop using and ask qualified VISCOUNT service staffs to examine and repair the device.

Warning about humidity

- * In case of any liquid splashing into the device, please do not get this device rained or use it nearby water, in a wet surrounding or put a container of liquid on it. If any liquid, like water, splashes into the instrument, please cut off power and pull out the electric cable from the AC socket immediately. Then ask qualified VISCOUNT service staffs to examine and repair the device.
- * Do not plug with wet hands.

Fire

- * Do not place any burning stuff, like candle, on the instrument. It may cause fire.
- * When sensing any unusual situations, such as worn away and damage of power cable, sound suddenly stops during playing and the smell and smoke it causes, please turn off the power immediately and pull out plug from the socket. Ask qualified VISCOUNT service staffs to examine and repair the device.

Attention

In case that people around you and you get injured or get loss of device and property, please obey the following basic instructions. These instructions include but not limited to following situations.

Power/Electric Cable

- * When pulling out plug from socket, please grab the plug instead of power cable. Drawing directly will cause damage to the power cable.
- * If not using the instruments for a long time or during a lighting storm, please pull out plug from the socket.

- * Do not connect the instrument to the socket by multiple connector, or it will lower the sound quality, or it will make socket overheat.

Assemble Use

- * Please carefully read the attachment that explains the assemble process. If assembling the instrument in a wrong order, it will damage the instrument and hurt the user.
- * Please connect the external equipment while the digital piano is off.
- * Before using, please install the supporting screw and adjust it close to the ground, in case of trampling pedal.

Installation place

- * In case of deformation of control panel and damage to inner components, please do not place this device in an environment with a lot of dirt, vibration, extreme cold and hot (such as, direct sunshine, closing to heater and inside a car under the burning sun)
- * Please do not use this device near the television, radio, stereo, cell phone or other electronic devices. This may make noise on the device itself and

television or radio nearby.

- * Please do not put this device on unstable place, or it may cause a sudden fall down.
- * Before moving the device, please pull out all electric cables from the socket.
- * When you set this device, please confirm the AC socket going to be used is reachable. The device should be connected to the socket with protecting grounding connection. If you find any problems and questions, please immediately turn off the power and pull out the plug from the socket. Even though the power is turned off, there is still a small amount of electricity current flowing through it. If you decide not using this device for a long time, please pull out the plug from AC socket.
- * This product uses all extreme power switch as a device to cut off from network power. The power switch button is on the right side of the keyboard. When the power button is pressed, it is switched on. When the power button up rises, it is switched off.

The graphic and screen in this hand book is only for introduction purpose. It may be different from the instrument you buy.

INDEX

Installation Guideline	8
Control Panel	9
Power\Adjust Volume\Connect the Headphone	10
Demo song\Sound	11
Function\1) Chord	12
2) Octave	13
3)Transpose	14
4)Soundboard resonance\5) Effect	15
6) Reverb	16
7)Chorus\8) Beat	17
9)Touch	18
10)Split\Touch switch.....	19
Sound choosing.....	20
Record and Play	23

Metronome	24
Using Accompaniment	25
Dual Sound	28
Double Keyboard	29
Rear panel function/USB MIDI function	31
Bluetooth MP3 Function	32
Audio connecting.....	34
Voices list	35
Rhythm list	39
MIDI keyboard percussion music list	40
Demo List	44
Specification	45
Troubleshooting	47

Thank you for buying VISCOUNT Digital Piano. No matter you are a student, piano hobbyist or the professional, this digital piano will impress you with its perfect sound and fashion design. It can be competent with piano studying, music listening, MIDI production, which satisfies your entertainment demand. It also has grand hammer dynamics keyboard, making you express yourself easily.

For further information about this new digital piano, we suggest you should read this hand book carefully in order to make full use of its advanced and convenient functions. Meanwhile, we also suggest you should keep this hand book well for reference in the future.

If you like VISCOUNT digital piano, please recommend VISCOUNT to your friends.

Installation Guideline

During the installation process, the screws under the pedal must be screwed close to the ground. Or it will be easily broken down.

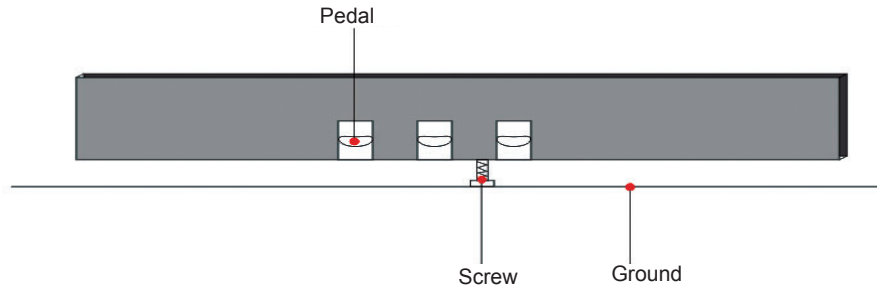

Control Panel

All the function keys are on the left side control panel of the digital piano.

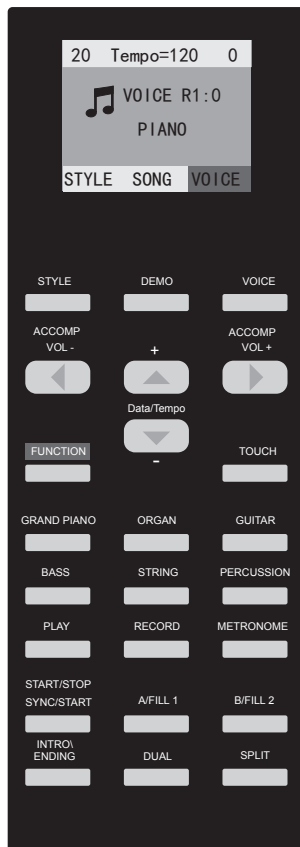

Power On

Connect the plug to a proper socket and then press the **【Power】** button on the right side of the keyboard to turn on. The default sound is grand piano.



Adjust Volume

Turn the Volume knob on the control panel to set the volume. Turn the knob clockwise to raise volume. Turn the knob anticlockwise to reduce volume.

Warning: Too loud sound, especially when you wear the headphone, will do damage to hearing.

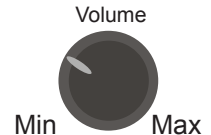

Headphone Connection

You can connect standard stereo headphone except the built-in sound amplifying system. The headphone jack are at the rear panel. The headphone jack is mute interface which automatically shuts off the speakers when using it. You can use the volume knob to adjust the sound level.



Demo Song

1. Press[Demo]button,the light is on and the screen shows the demo song and play automatically. Press[Data/Tempo+/-] to choose the demo song you want.
2. Press[Demo]button again, the light is off and the demo playing function will be stop.

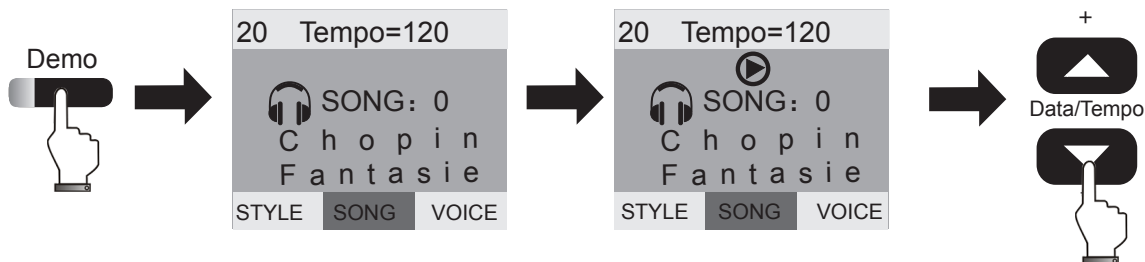

Voices

1. Press[VOICE]button,the light is on and the screen shows the sound. Press[Data/Tempo+/-] to choose the voice you want.[For the voices list, please see the Appendix]
2. No operation within 5seconds,the voice light will be off and exit the voice function automatically.

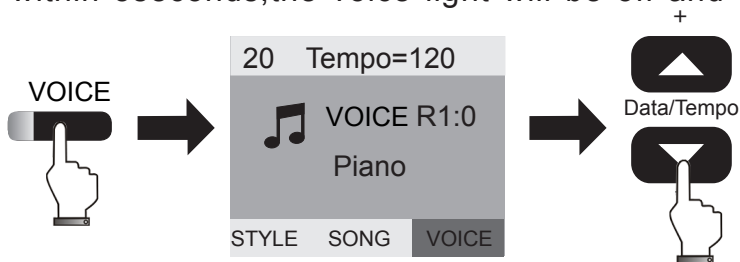

Function

The instrument is easy to handle. All the functions are easy to be activated and every key has a function for you to use. (The function is printed on the front of the key)

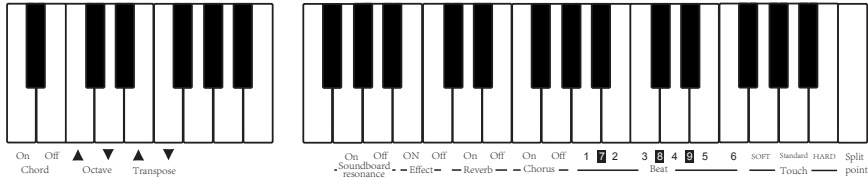

1. Press [Function] button, the function light will be on and activated, then press the corresponding key for the function you need.
2. Press the [Function] button again or no operation within 5 seconds. The function light will be off and exit the function setting. Here the keyboard has the corresponding function which you choose. **(Note: when you are in the function setting status, the keyboard is silent)**

1) Chord

1. The piano has Chord function: Press [Function] button, the function light is on and screen shows "Function choosing"; Press the [Chord on] key within 5 seconds. The screen shows "Chord:On" means that the chord function is on.

2. Press[Function]key, the function light is on,then press[Chord off]key,The screen show"Chord:Off" mean that the chord function is off.

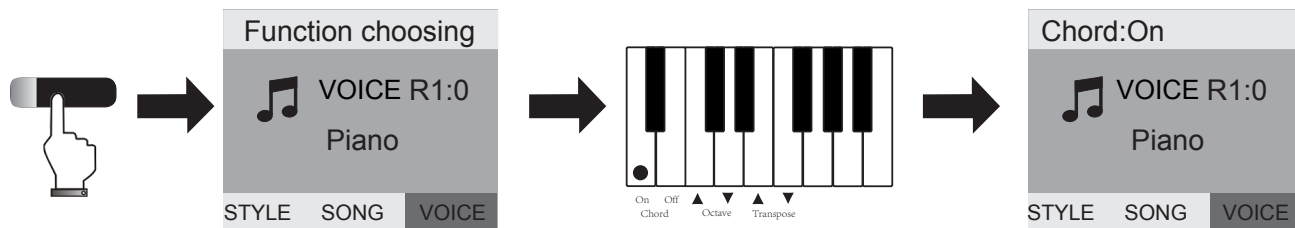

2) Octave

- 1.Press[Function]button, the function light is on, the screen shows"Function choosing"
Press[Octave+/-]key, the screen shows"Octave:-1,0,+1"on the top then you can adjust the octave of the keyboard.
- 2.Press[Function]button again or no operation within 5 seconds, the light will be off and exit the keyboard pitch setting.

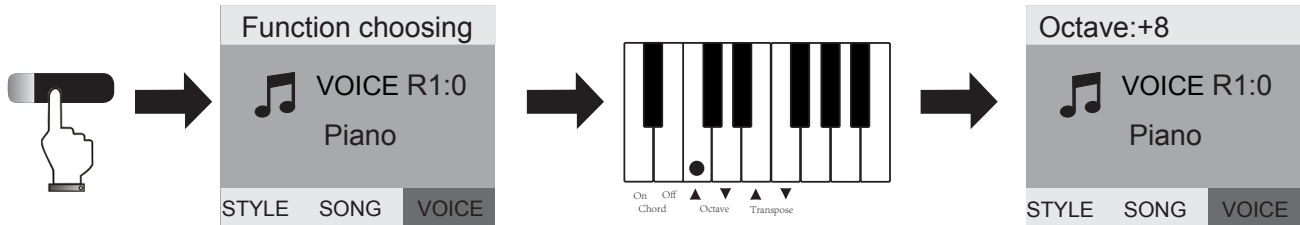

3) Transpose

With this function you can sharp or flat a semitone of twelve in the octave.

1. Press[Function]button, the light on, the screen show"Function choosing"
Press[Transpose+/-]key, the screen shows"Transpose+1/-1",then adjust the pitch between -12 and +12.
2. Press[Function]button or no operation within 5seconds, the light is off and shut off the Transpose function.

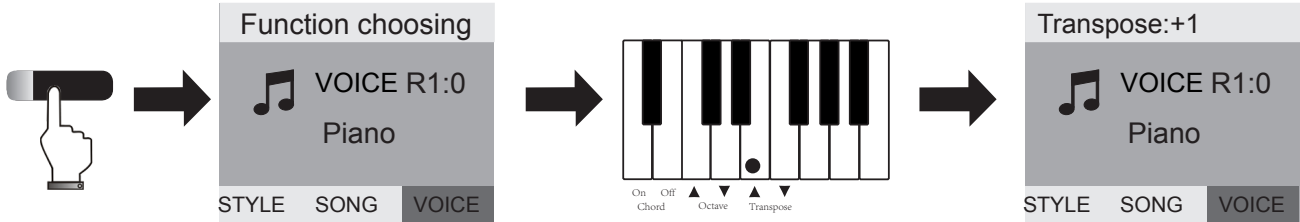

4) Soundboard Resonance

1. Press[Function]button, the light is on, the screen show"Function choosing"

Press[Soundboard resonance On]key, the screen shows"Soundboard resonance:On",then the soundboard resonance function is activated and it will have the resonance effect when playing.

2.Press[Function]button,and the light is on,Press[Soundboard resonance Off]key within 5seconds, screen shows"Soundboard resonance:Off" and shut off the Soundboard resonance function.

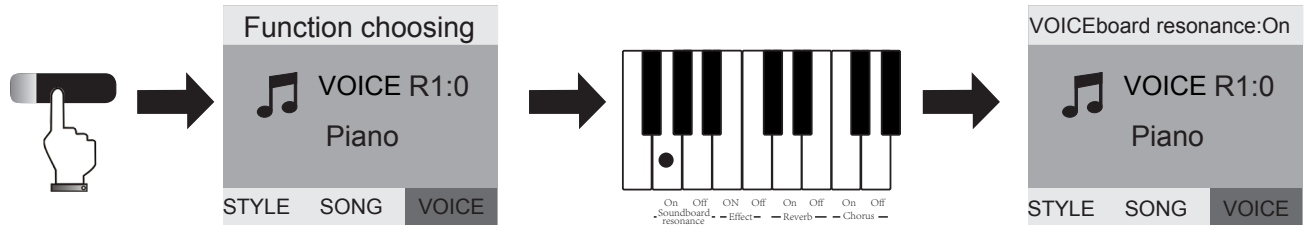

5) Effect

1. Press[Function]Button, the light is on and the screen shows"Function choosing"

Press[Effect On]key within 5 seconds, and the screen shows"Effect:On" means the effect function is activated and it will have the special effect when playing.

2. Press[Function]button, the light is on, press the[Effect off]key within 5 seconds, The screen shows”Effect:Off” and shut off the effect function.

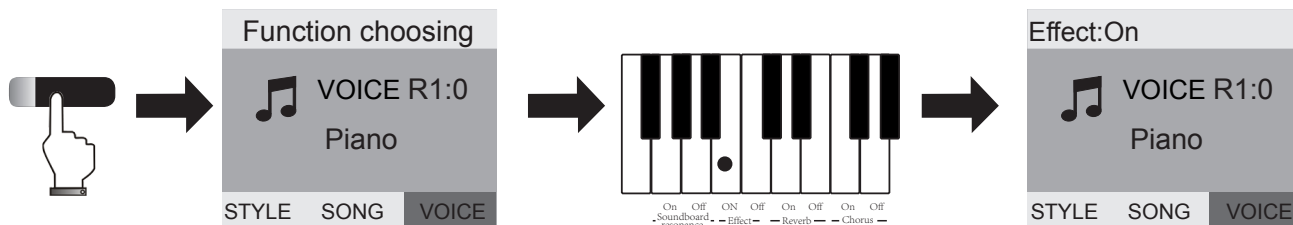

6) Reverb

1. Press[Function]Button, the light is on and the screen shows”Function choosing”
 Press[Reverb On]key within 5 seconds, and the screen shows”Reverb:On” means the Reverb function is activated and it will have the Reverb effect when playing.

2. Press[Function]button, the light is on, press the [Reverb off]key within 5 seconds, The screen shows”Reverb:Off” and shut off the reverb function.

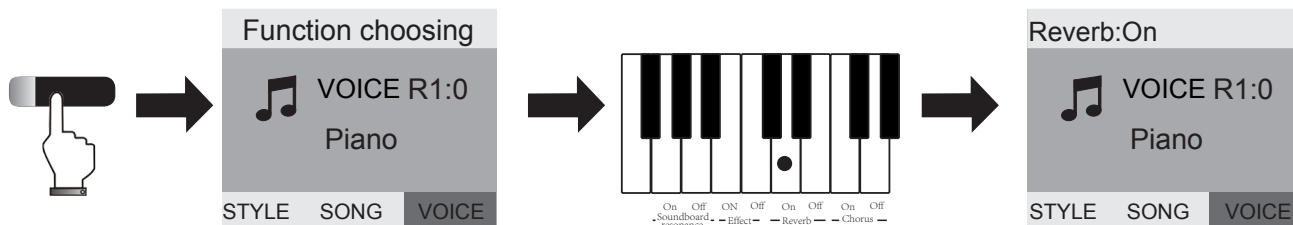

7) Chorus

1. Press[Function]Button, the light is on and the screen shows"Function choosing"
Press[Chorus On]key within 5 seconds, and the screen shows"Chorus:On" means the Chorus function is activated and it will have the Chorus effect when playing.
2. Press[Function]button, the light is on, press the [Chorus off]key within 5 seconds, The screen shows"Chorus:Off" and shut off the Chorus function.

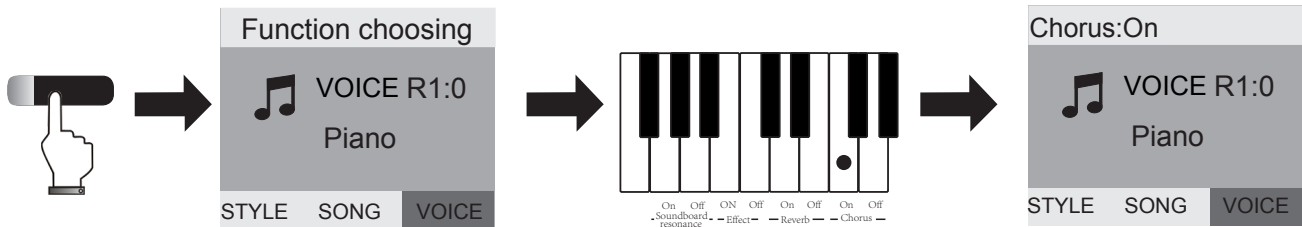

8) Beat

- 1.The instrument has 9 beats, 1,2,3,4,5,6,7,8,9 respectively. Press[Function]button, the light is on and screen shows"Function choosing"
Press the corresponding beat key, the screen shows the corresponding beat, then choose the one you need.
- 2.Press[Function]button again or no operation within 5 seconds, The light is off and confirm the best setting (7,8,9 correspond to the black keys above)

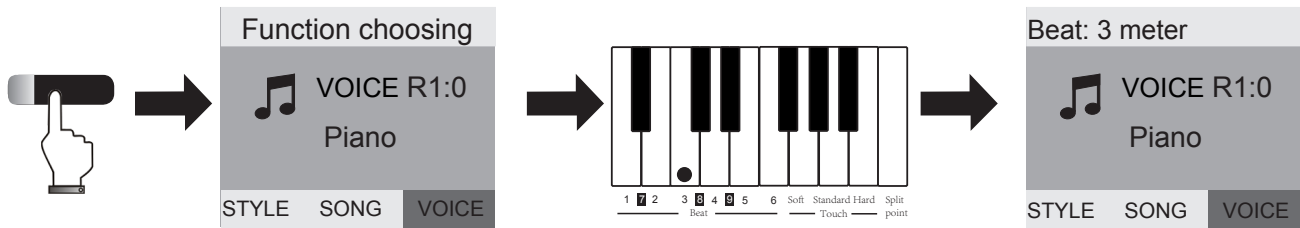

9) Touch

1. There are 5 touch curves, Default, Soft, Standard, Hard, Touch Off. Press[Function]button, the indicated light is on and screen shows"Function choosing"

Press the corresponding touch key within 5 seconds, the screen shows the corresponding touch means the keyboard touch function is activated.

2. Press[Function]button again or no operation within 5 seconds, The light is off and exit the touch setup function.

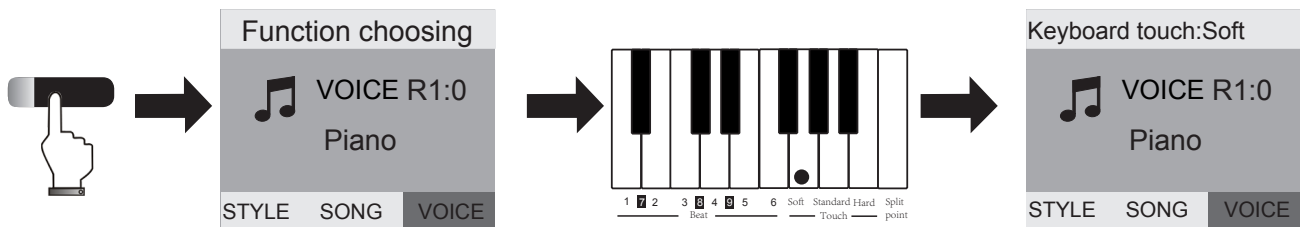

10) Split

1. Press[Function]button, the indicated light is on and screen shows"Function choosing"
Press the[Split]key within 5 seconds, the screen shows "keyboard split point=65" means the keyboard get in the Split setting status.
2. Press[Function]button again or no operation within 5 seconds, The light is off and confirm the Split point setting.

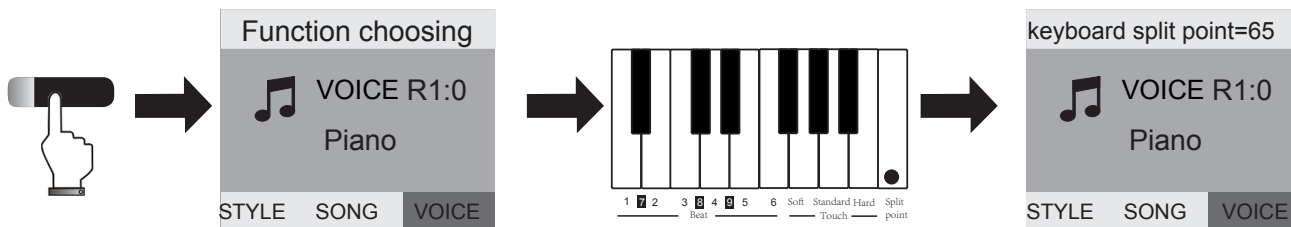

Touch Switch

1. Touch On: The default touch is on when you turn on the instrument.
2. Touch Off: Press[Touch]button and the indicated light off, the Touch Function Off.



Voice Choosing

Grand piano: Grand piano voice is default voice,when you turn on the instrument, the Grand piano voice light will be on.

Organ: Press[Organ]Button, the indicated light [Organ]and[VOICE] buttons will be on at the same time. The screen shows “Church Organ” and get in the Organ voice.

Press[Data/Tempo +/-] button to choose other voices. (The[VOICE] indicated light will be off and exit the Organ voice setting function when there is no operation within 5 seconds)

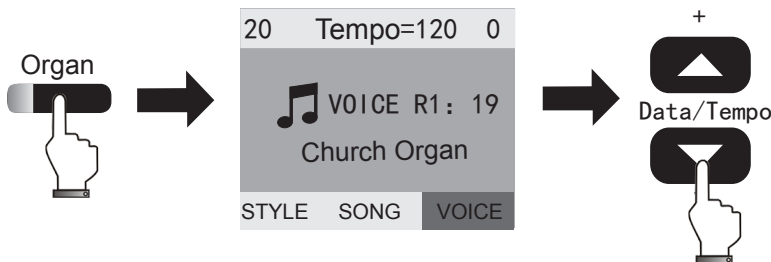

Guitar: Press[Guitar]Button, the indicated light [Guitar]and[VOICE] buttons will be on at the same time. The screen shows “Classical Guitar” and get in the Guitar voice.

Press[Data/Tempo +/-] button to choose other voices. (The[VOICE] indicated light will be off and exit the Guitar voice setting function when there is no operation within 5 seconds)

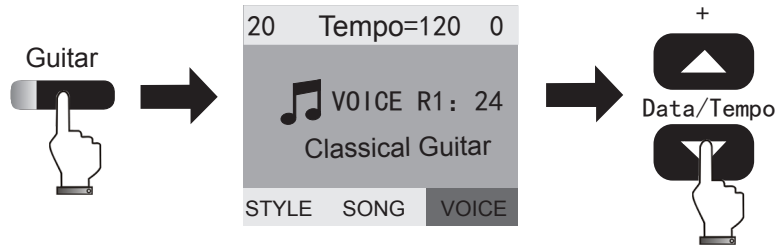

Bass: Press[Bass]Button, the indicated light [Bass]and[VOICE] buttons will be on at the same time. The screen shows “Acoustic Bass” and get in the Bass VOICE.Press[Data/Tempo +/-] button to choose other voices. (The[VOICE] indicated light will be off and exit the Bass voice setting function when there is no operation within 5 seconds)

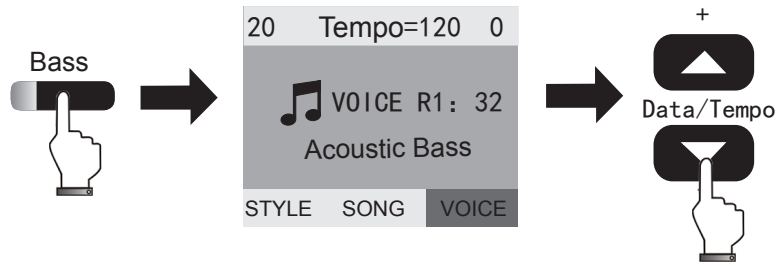

Strings: Press[Strings]Button, the indicated light [Strings]and[VOICE] buttons will be on at the same time. The screen shows “String Ensemble1” and get in the String VOICE. Press[Data/Tempo +/-] button to choose other voices.(The[VOICE] indicated light will be off and exit the String voice setting function when there is no operation within 5 seconds)

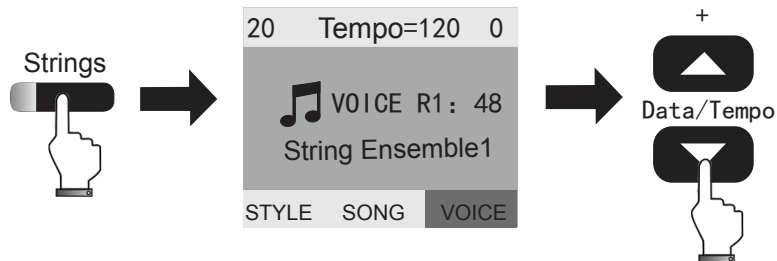

Percussion: Press [Percussion] button, the indicated light is on, the screen shows "GM standard kit". Then press [VOICE] button again. The indicated light on and get in the percussion sound setting. Press Data/Tempo +/- button to choose other voices. (The [VOICE] indicated light will be off and exit the Percussion sound setting function when there is no operation within 5 seconds)

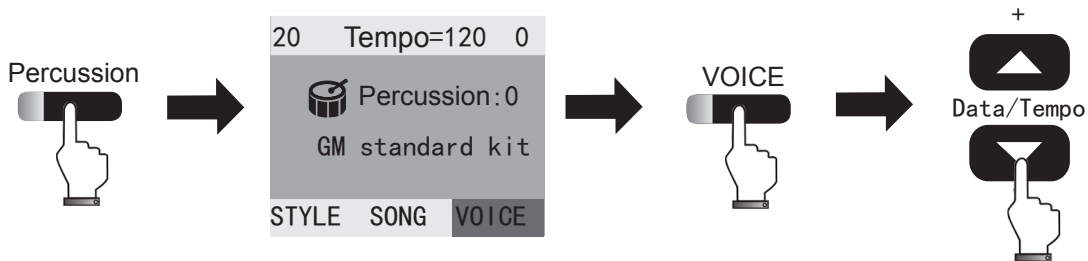

Record and Play

The digital piano can record the music you played, including the build-in accompaniment of the piano. Operation as follows:

Record: 1. Press [Record] button and the indicated light on, the metronome function will be turned on and record. If you want to turn off the metronome voice, press [Metronome] to close it.

2. Press [Record] button, the indicated light off and exit the record function.

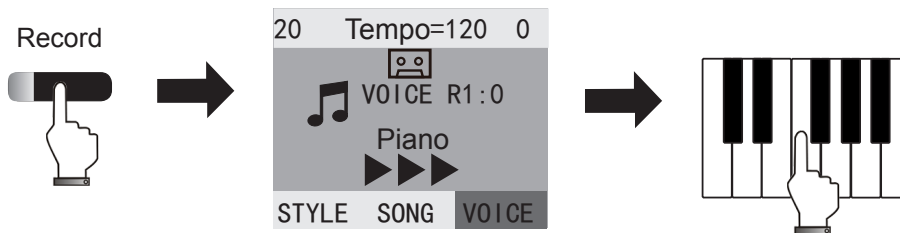

Play: 1. Press [Play] button, the indicated light on, the screen shows you the music is playing as the icon below. (The music you recorded will be played.)

2. After playing, the indicated light off and the playing icon will be disappeared.

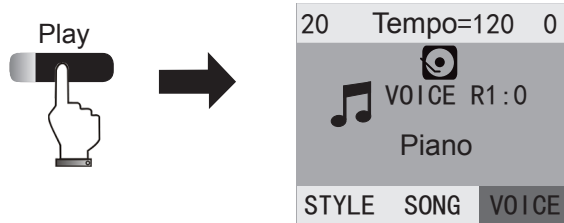

Metronome

1. Press[Metronome]button, the indicated light on, the screen show the blink icon“ ▶▶▶ ” and the metronome voice sound.
2. Press[Data/Tempo +/-], the screen shows “ Tempo=120” (Default), In the moment, you can adjust the tempo by press the [Data/Tempo +/-]button.
- 3.Press[Metronome]button, the indicated light off and exit the metronome setting function.

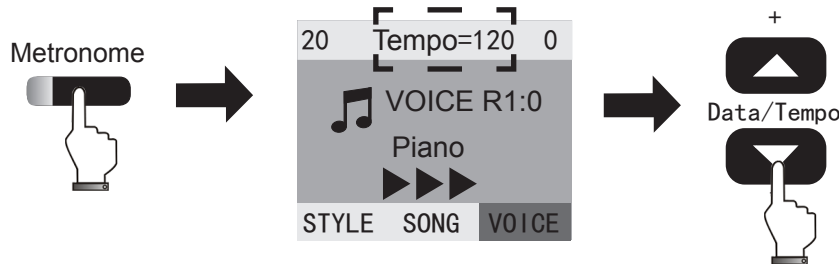

Using Accompaniment

Playing with the accompaniment makes your music more expressive and emits interest into your music:

STYLE: 1. Press[Accomp]button, the indicated light on, the screen shows“STYLE”.

Press[Data/Tempo +/-] button to choose the rhythm, the screen will show the corresponding name of the rhythm.

2. No operation within 5 seconds, the indicated light off and exit the rhythm function automatically.



Accomp volume-/+: 1. Press[Accomp vol+/-] button, the screen show”20”(Default) on the top left. When you adjust the volume by pressing the [Accomp vol+/-], it will show corresponding figure.(Accomp volume:0-32)

2. After adjusting, the accomp volume function will be exited automatically.

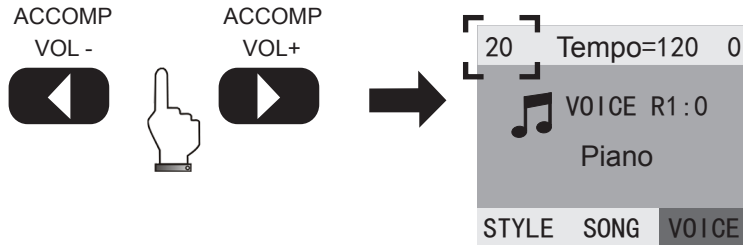

Start/Stop: Press the [Start/Stop] button, it will control the accompaniment.

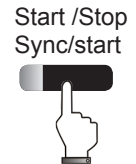

Sync/Start: 1.Long press[Sync/Start] button, the screen show three blinking triangular symbols (When the chord function off, press any keys the automatic accompaniment will be activated. If the chord function is on, press the corresponding key of the Chord.)

2. Press[Sync/Start] button, the accompaniment will be stopped.

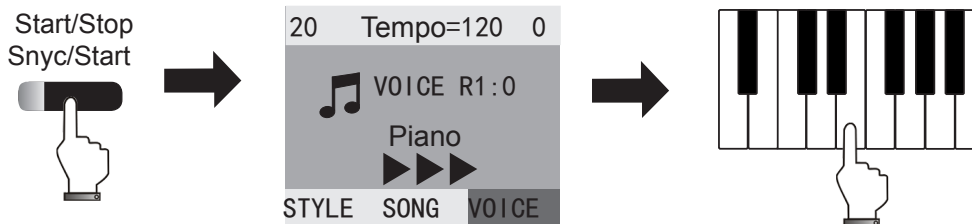

A/fill 1: 1. When [A/fill 1] button is on(default status), Press[Start/Stop] button, the screen shows three blinking triangular symbols.

2. Press[A/fill 1] button, the indicated light is on. Accompaniment inserts A rhythm.

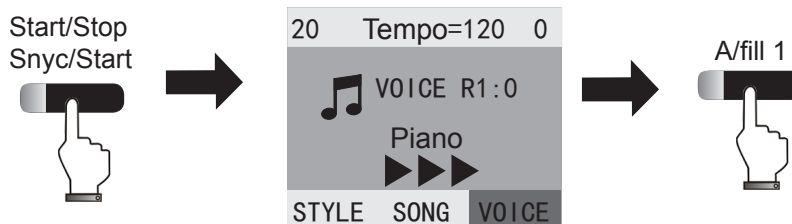

B/fill 2: 1. Press[Start/Stop] button, the screen shows three blinking triangular symbols, Accompaniment voices.

2. Press[B fill 2] button, the indicated light is on. Accomp inserts B rhythm.

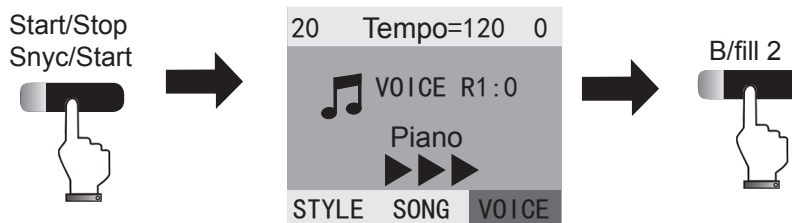

INTRO\ENDING :1. Press[INTRO\ENDING] button, the [Start/Stop] indicated light will be on simultaneously. The screen shows 3 blinking triangular symbols,the Prelude will be inserted into your music.

2. Press [INTRO\ENDING] button, the indicated light is on, the finale will be inserted into your music. Then the indicated light off and accomp stop.

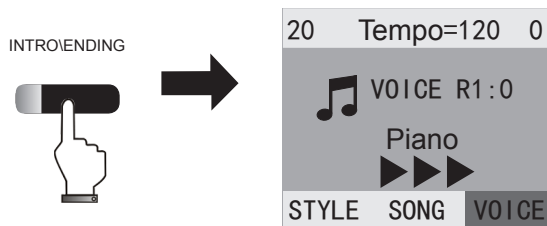

Dual Voices

1. Press[Dual] button to get in the dual voice status, the indicated light on, the default voice is the second voice:048 STRINGS1.

2. Press [Data/Tempo +/-]button to select other second voice. The first voice setting needs to adjust before pressing [Dual] button.

3. Press[Dual] button turn off the dual voice effect and back to the first voice.

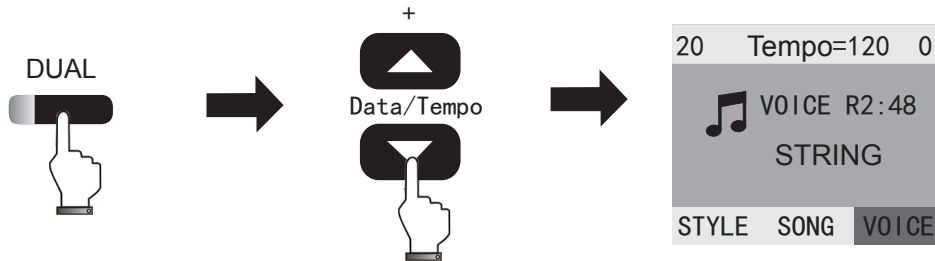

Double Keyboard

The function divides the keyboard into two separated operating areas.

Left side keyboard ← → Right side keyboard

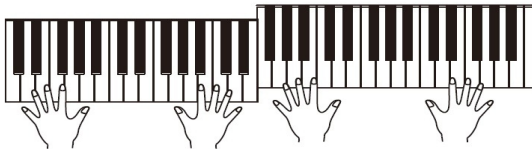

1. Select the voice of left side keyboard before pressing [SPLIT] button. Press [VOICE] button, the indicated light on, then press [Data/Tempo +/-] button to select the voice.
2. Press [SPLIT] button to get into the double keyboard status, the keyboard will be divided into two separated operating areas. The default split point is C. Press [VOICE] button, select the voice of right side keyboard by pressing [Data/Tempo +/-] button.

3. Press [SPLIT] button to exit the double keyboard status.

Select the voice of
left side keyboard

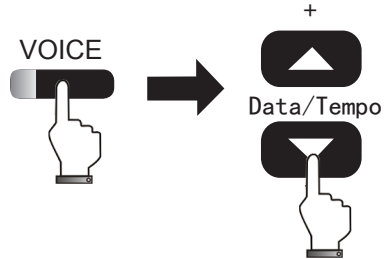

Select the voice of
right side keyboard

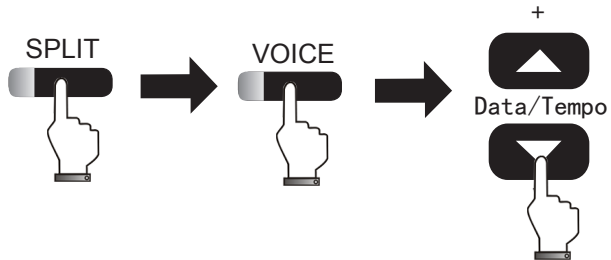

Rear Panel Function

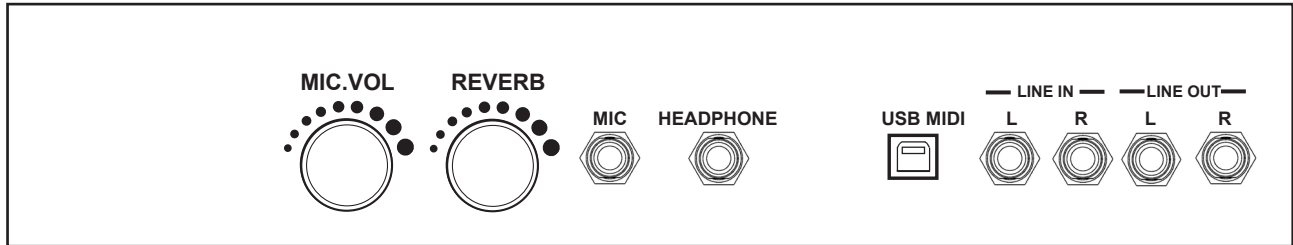

- (1) MIC.VOL (2) REVERB (3) MIC (4) HEADPHONE (5) USB MIDI (6) LINE IN
(7) LINE OUT

USB MIDI Function

- Connecting the digital piano from the back board USB jack to the host of PC, to start MIDI music production.

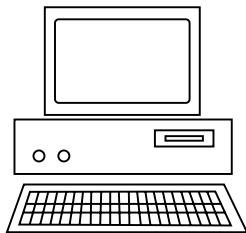

USB TO HOST Connecting

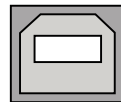

USB MIDI jack of back board

Left side Indicator light board/USB connector



Bluetooth MP3 Function

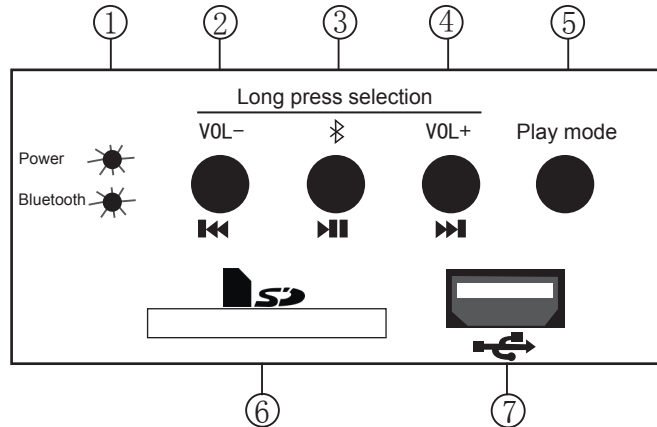

- 1. Status indicated light:** the red light means in USB, SD status; the blue light means in Bluetooth status.
- 2. Previous music/ Volume down:** short press the button will be turned to previous music. Long press the button will turned down the volume.
- 3. Play-pause/Bluetooth:** short press the button will be switched play or pause mode. Long press the button will be Bluetooth pairing function.
- 4. Next music/ Volume up:** short press the button will be turned to next music. Long press the button will turned up the volume.

5. Play mode: Switch between USB\SD and Bluetooth mode.

6. SD card connector: SD card input for playing MP3 files from the SD card.

7. USB connector: USB input for playing MP3 files from USB pen-driver.

USB、SD card operating instructions:

When the instrument is on, the Bluetooth function standby. Insert the USB or SD card and the system get in the loading status with blinking LED red light. To select the music from your USD/SD card by pressing [◀◀] or [▶▶]. Perhaps the [▶▶] button to pause/play music. When in pause status, the red LED light will be on.

Bluetooth operating instructions:

Long press [✂] to get in the Bluetooth pairing status, the blue LED light flashing slowly. At the moment, search the Bluetooth to pair with your cellphone. After pairing, it can play the music from your phone or other Bluetooth units. When playing, the blue LED light flash quickly, then you can select the music by pressing [◀◀] or [▶▶]. Or press the [▶▶] Pause/Play music button to set it. When in pause status, the blue LED flash slowly.

In USB,SD loading status, if you need to switch to Bluetooth play, you need to press [play mode] button to switch Bluetooth mode then do the Bluetooth pairing.

Audio Connecting

- Audio input: To make the digital piano as a speaker by connecting the digital piano internal speaker system with other instrument.



Audio connecting

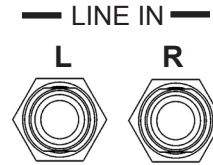

- Audio output: To make the digital piano as a sound source by connecting the digital piano with external amplifying system.



Audio connecting

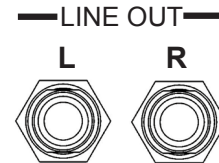

Sound List

Number	Instrument
PIANO	
00	Grand Piano
01	Bright Piano
02	Electric Piano
03	Honky-Tonk Piano
04	Rhodes Piano
05	Chorused Piano
06	Harpsichord
07	Clavinet
GLOCK	
08	Celesta
09	Glockenspiel
10	Music Box
11	Vibraphone
12	Marimba
13	Xylophone
14	Tubular Bells
15	Dulcimer

ORGAN	
16	Hammond Organ
17	Percussive Organ
18	Rock Organ
19	Church Organ
20	Reed Organ
21	Accordion
22	Harmonica
23	Tango Accordion
GUITAR	
24	Guitar (nylon)
25	Guitar(steel)
26	Ele. Guitar (jazz)
27	Ele. Guitar(clean)
28	Ele. Guitar(muted)
29	Overdriven Guitar
30	Distortion Guitar
31	Guitar Harmonics
BASS	
32	Acoustic Bass
33	Ele. Bass(finger)

34	Ele. Bass(pick)
35	Fretless Bass
36	Slap Bass 1
37	Slap Bass 2
38	Synth Bass 1
39	Synth Bass 2
STRING	
40	Violin
41	Viola
42	Cello
43	Contrabass
44	Tremolo Strings
45	Pizzicato Strings
46	Orchestral Harp
47	Timpani
CONCERT	
48	String Ensemble 1
49	String Ensemble 2
50	SynthStrings 1
51	SynthStrings 2
52	Choir Aahs

53	Voice Oohs
54	Synth Voice
55	Orchestra Hit
BRASS	
56	Trumpet
57	Trombone
58	Tuba
59	Muted Trumpet
60	French Horn
61	Brass Section
62	Synth Brass 1
63	Synth Brass 2
PIPE	
64	Soprano Sax
65	Alto Sax
66	Tenor Sax
67	Baritone Sax
68	Oboe
69	English Horn
70	Bassoon
71	Clarinet

WOODPIPE	
72	Piccolo
73	Flute
74	Recorder
75	Pan Flute
76	Bottle Blow
77	Shakuhachi
78	Whistle
79	Ocarina
SYNTH PIPE	
80	Ld. 1 (square)
81	Ld. 2 (sawtooth)
82	L. 3 (calliope lead)
83	Ld. 4 (chiff lead)
84	Ld. 5 (charang)
85	Ld. 6 (voice)
86	Ld. 7 (fifths)
87	Lead 8 (bass+lead)

SYNTH VOICE	
88	Pad 1 (new age)
89	Pad 2 (warm)
90	Pad 3 (polysynth)
91	Pad 4 (choir)
92	Pad 5 (bowed)
93	Pad 6 (metallic)
94	Pad 7 (halo)
95	Pad 8 (sweep)
SYNTH EFFECT	
96	FX 1 (rain)
97	FX 2 (soundtrack)
98	FX 3 (crystal)
99	FX 4 (atmosphere)
100	FX 5 (brightness)
101	FX 6 (goblins)
102	FX 7 (echoes)
103	FX 8 (sci-fi)

FOLK SOUND	
104	Sitar
105	Banjo
106	Shamisen
107	Koto
108	Kalimba
109	Bagpipe
110	Fiddle
111	Shanai
PERCUSSION	
112	Tinkle Bell
113	Agogo
114	Steel Drums
115	Woodblock
116	Taiko Drum
117	Melodic Tom
118	Synth Drum
119	Reverse Cymbal

EFFECT	
120	Guitar Fret Noise
121	Breath Noise
122	Seashore
123	Bird Tweet
124	Telephone Ring
125	Helicopter
126	Applause
127	Gunshot

Rhythm List

Number	Name
00	8 Beat 1
01	8 Beat Pop 1
02	16 Beat 1
03	Guitar Ballad
04	Pop Ballad
05	Country Rock
06	Country Waltz
07	Salsa
08	Disco
09	Two Step
10	Polk Pop
11	80' s Fusion
12	Swing 1
13	Jazz Samba
14	Jive
15	Bebop
16	Cha Cha
17	TEX TEX

Number	Name
18	Rap
19	Blues
20	Rock 1
21	Rock 2
22	Rock Shuffle
23	March
24	Samba
25	Polka Ober
26	Miami Pop
27	Piano Ballad
28	Bossa Nova 2
29	Guitar Waltz

Drum Kit Set List

MIDI note#		1-Standard	2-Room	3-Power	4-Electric	5-Synth
27	C1	Syn Sound	Syn Sound	Syn Sound	Syn Sound	Syn Sound
28	C#1	Slap	Slap	Slap	Slap	Slap
29	D1	Scratch1	Scratch1	Scratch1	Slap	Scratch1
30	D#1	Scratch2	Scratch2	Scratch2	Scratch2	Scratch2
31	E1	Sticks	Sticks	Sticks	Sticks	Sticks
32	F1	Click	Click	Click	Click	Click
33	F#1	Metronome Click	Metronome Click	Metronome Click	Metronome Click	Metronome Click
34	G1	Metronome Bell	Metronome Bell	Metronome Bell	Metronome Bell	Metronome Bell
35	G#1	Kick2	Kick2	Kick2	Eleotry Kick2	Kick2
36	A1	Kick1	Kick1	Power Kick1	Eleotry Kick1	Synth Kick
37	A#1	Side Stick	Side Stick	Side Stick	Side Stick	Synth Side Stick
38	B1	Snare Drum2	Snare Drum2	Power Snare	Eleotry Snare Drum2	Synth Snare
39	C2	Hand Clap	Hand Clap	Hand Clap	Hand Clap	Hand Clap
40	C#2	Snare Drum1	Room Snare1	Snare Drum1	Eleotry Room Snare 1	Snare Drum1

41	D2	Low Tom2	Power Low Tom2	Power Low Tom2	Eleotry Low Tom2	Synth Low Tom2
42	D#2	Closed Hi-Hat	Closed Hi-Hat	Closed Hi-Hat	Closed Hi-Hat	Synth Closed Hi-Hat
43	E2	Low Tom1	Power Low Tom1	Power Low Tom1	Eleotry Low Tom1	Synth Low Tom1
44	F2	Pedal Hi-Hat	Low Tom1	Pedal Hi-Hat	Pedal Hi-Hat	Synth Pedal Hi-Hat
45	F#2	Mid Tom2	Power Mid Tom2	Power Mid Tom2	Eleotry Mid Tom2	Synth Mid Tom2
46	G2	Open Hi-Hat	Open Hi-Hat	Open Hi-Hat	Open Hi-Hat	Synth Open Hi-Hat
47	G#2	Mid Tom1	Power Mid Tom1	Power Mid Tom1	Eleotry Mid Tom1	Synth Mid Tom1
48	A2	High Tom2	Power High Tom2	Power High Tom2	Eleotry High Tom2	Synth Tom2
49	A#2	Crash Cymbal	Crash Cymbal	Crash Cymbal	Crash Cymbal	Synth Crash Cymbal
50	B2	High Tom1	Power High Tom1	Power High Tom1	Power High Tom1	Synth High Tom1
51	C3	Ride Cymbal	Ride Cymbal	Ride Cymbal	Ride Cymbal	Ride Cymbal
52	C#3	Chinese Cymbal 1	Chinese Cymbal	Chinese Cymbal 1	Chinese Cymbal 1	Chinese Cymbal 1
53	D3	Ride Bell	Ride Bell	Ride Bell	Ride Bell	Ride Bell

54	D#3	Tambourine	Tambourine	Tambourine	Tambourine	Tambourine
55	E3	Splash Cymbal	Splash Cymbal	Splash Cymbal	Splash Cymbal	Splash Cymbal
56	F3	Cowbell	Cowbell	Cowbell	Cowbell	Cowbell
57	F#3	Crash Cymbal	Crash Cymbal	Crash Cymbal	Crash Cymbal	Crash Cymbal
58	G3	Vibra-Slap	Vibra-Slap	Vibra-Slap	Vibra-Slap	Vibra-Slap
59	G#3	Ride Cymbal	Ride Cymbal	Ride Cymbal	Ride Cymbal	Ride Cymbal
60	A3	High bombo	High bombo	High bombo	High bombo	High bombo
61	A#3	Low conga	Low conga	Low conga	Low conga	Low conga
62	B3	Mute conga	Mute conga	Mute conga	Mute conga	Mute conga
63	C4	High conga	High conga	High conga	High conga	High conga
64	C#4	Low conga	Low conga	Low conga	Low conga	Low conga
65	D4	High Timbale	High Timbale	High Timbale	High Timbale	High Timbale
66	D#4	Low Timbale	Low Timbale	Low Timbale	Low Timbale	Low Timbale
67	E4	High Agogo	High Agogo	High Agogo	High Agogo	High Agogo
68	F4	Low Agogo	Low Agogo	Low Agogo	Low Agogo	Low Agogo
69	F#4	Cabasa	Cabasa	Cabasa	Cabasa	Cabasa
70	G4	Msracas	Msracas	Msracas	Msracas	Msracas

71	G#4	Short Hi Whistle	Short Hi Whistle	Short Hi Whistle	Short Hi Whistle	Short Hi Whistle
72	A4	Long low whistle	Long low whistle	Long low whistle	Long low whistle	Long low whistle
73	A#4	ShortGuiro	ShortGuiro	ShortGuiro	ShortGuiro	ShortGuiro
74	B4	logn Guiro	logn Guiro	logn Guiro	logn Guiro	logn Guiro
75	C5	Claves	Claves	Claves	Claves	Claves
76	C#5	Hi Wood Block	Hi Wood Block	Hi Wood Block	Hi Wood Block	Hi Wood Block
77	D5	Low Wood Block	Low Wood Block	Low Wood Block	Low Wood Block	Low Wood Block
78	D#5	Mute Cuica	Mute Cuica	Mute Cuica	Mute Cuica	Mute Cuica
79	E5	Open Cueca	Open Cueca	Open Cueca	Open Cueca	Open Cueca
80	F5	Mute Triangle	Mute Triangle	Mute Triangle	Mute Triangle	Mute Triangle
81	F#5	Open Triangle	Open Triangle	Open Triangle	Open Triangle	Open Triangle
82	G5	Shaker	Shaker	Shaker	Shaker	Shaker
83	G#5	Jingle Bell	Jingle Bell	Jingle Bell	Jingle Bell	Jingle Bell
84	A5	Bell Tree	Bell Tree	Bell Tree	Bell Tree	Bell Tree
85	#5	Castanets	Castanets	Castanets	Castanets	Castanets
86	B5	Mute Surdo	Mute Surdo	Mute Surdo	Mute Surdo	Mute Surdo
87	C6	Open Surdo	Open Surdo	Open Surdo	Open Surdo	Open Surdo

Demo List

Number	Demo Name
000	Chopin Fi
001	Bach Piano
002	Minuet Bach
003	Love Romance
004	Four Cygnets
005	Puppy Wlatz
006	CpnEtude
007	Turkey March
008	Chopin No.6
009	Menuett
010	MarciaAT
011	Chopin Night
012	Piano Ballad
013	Ragetime
014	Fn Rhythm
015	Dolly's Dream
016	4 Cygnets
017	Old France
018	Minuet Bath
019	Song of Joy
020	Doves
021	Curvet Piano
022	Spring Waltz

023	Aledeman
024	Bach 2 Creative
025	Moonlight Debussy
026	Gavotte Dance
027	Canon Piano
028	Cowboy & Flute
029	Turkey March
030	Humoresque
031	England March
032	Little Boat
033	Minuet Piano
034	Jingle Bells
035	Moscow Nights
036	Rainbow
037	Oh, Susanna
038	Lonely Goatherd
039	Missing In Moonlight
040	Old Black Joe
041	Santa Lucia
042	Good Scenery
043	Jambalaya
044	Little Cowboy

045	Fowing Stream
046	Little Swallow
047	Heart Love
048	Kaiser Waltz
049	Blue Danube Waltz

Specifications

Technical Specifications	Classico
Keyboard :	88 Keys, Grand Touch Feeling- Grand Hammer Action
Sound Generation:	S-512 Sound Engine
Maximum Polyphony:	512 Notes
Voice:	128
Demo:	50 Demos
Touch Sensitivity:	Default, Soft, Standard, Hard, Touch off
Keyboard Modes:	Whole, Split, Dual, Double (Grand Piano, Dual voice, Double keyboard, Split mode, Split point)
Soundboard Resonance :	Yes
Rhythms:	30 Styles
Rhythm Controls:	Auto Chord Switch, SYNC Start, SYNC Stop, A/fill 1, B/fill 2, Intro\Ending
Recorder:	2 Tracks, replay supported, Maximum 22.000 notes for one single song. MIDI, 64 tracks and 16 channels, Support MIDI 0&1 file
Teaching System functions:	Yes, 100 songs, follow to practice.
Metronome:	Yes (Selectable Beat, adjustable tempo)
Volume Controls:	Master volume, Accompaniment volume (0-32)
Mic. Input:	Yes, with Volume adjustment
Connections:	1 Headphone, Audio In L/R, Audio Out L/R, USB to Host (Type B), USB to Host (Type A), USB Host (Type A), SD Card, Power Supply

Technical Specifications	Classico
External Audio Sources:	Bluetooth, USB, SD Card
Transposer :	-12 / +12 Semitones
Octave:	Octave -1/ 0 / +1
Reverb Effects:	64 Types
Modulation Effects:	64 Types
Tempo:	20-280 Bpm
Controls:	Main Volume, Mic. Volume, Reverb
Functions Panel Menu:	Style, Demo, Voice, Accomp.Vol. -/+, Data/Tempo, Function, Touch, Sound Family, Play, Record, Metronome, Start/Stop, Sync.Start, A/Fill 1, B/Fill 2, Intro/Ending, Dual, Spilt
Display:	Yes, LCD Display
Pedals:	Soft, Sustain, Sostenuto
Power Amplifier:	60W (2 x 25W Low Section, 2 x 5W High Section)
Speakers:	2 woofer(5"), 2 tweeter(2")
Dimensions (D x W x H) :	1434 x 512 x 1120 mm - (56,45" x 20,15" x 44,09")
Weight:	79 Kg - (174 lbs)
Power Supply:	AC230V, 70W.
Colours/Finish	Black high gloss and White high gloss
Included Accessoires:	Power cord, Guarantee card, Quality certificate, User manual
Optional:	Bench

Troubleshooting

Problem	Cause/Action
There is noise when turn on/off the power	This is normal , please don't worry.
After turning on, no sound is produced when press the keys	Please adjust the master volume or check if there is a headphone connected in the device.
The note and its timber are of a little differences under the same patch	This is normal.
When using the sustaining function, some patches are different long or short	This is normal.
The volume is too low	Please adjust the master volume knob.
MIDI transmission function fail when the MIDI Cord connecting well	This is normal.
Noise caused when near phone	This is normal, In order to avoid it please keep away when calling.
When playing piano, the pitch is not in accordance with the keyboard	Please check if you have activated the SPLIT mode function and turn it off.
Pitch can not be changed when playing piano, and the pitch is not in accordance with the keyboard	Please check if you have activated the SPLIT mode function and set the split point to the highest level, Turn off the split mode function and set the split point back to the original.

Distortion or intermittent when playing demo songs	The cause could be the overheating of the speakers,when you play for a long time with the maximum volume, at this point please lower the volume or turn the piano off for a while.
Two tones come out at the same time when playing	Dual sound function might by activated, please turn off it to avoid it.
Pitch wrong	Please confirm the pitch setting or set it to “Zero”
No automatic Accompaniment and Chord	Please confirm the accompaniment volume or if the Chord function is turned on.
Dynamics is not same as before	There are 5 piano touch curve, Default、 Soft、 Standard、 Hard、 Touch off. You might choose the wrong dynamics. Please set the one you need.

NOTE: This instrument has been tested and it is according with the relevant regulations of EMC. Wireless communication might caused the interference with this instrument. Or the instrument might caused the interference with wireless. The user should adopt the following measure to improve it.

Relocation or adjust the receiving antenna.

Keep a distance between the device and receiver.

Connect the receiver and the device cord in different plug.

Please consult your dealer or experienced wireless technician.

Caution:Do not modified the device by yourself.



Viscount International S.p.A.

Via Borgo, 68/70 - 47836 Mondaimo (RN) ITALY

Tel.: +39-0541-981700

www.viscountinstruments.com